



## About the product

Steelcraft B18, B16, and B14 Series flush doors are designed to meet the architectural requirements for full flush, steel stiffened doors. The door face sheets are supported by the internal steel stiffeners, which extend the full door width. The stiffeners are welded to (1) face sheet and bonded to the opposite panel.

The B Series Door offers a wide range of specifiable options including sizes, glass light designs, optional edge constructions and hardware (mechanical, pneumatic, electrical) preparations.

B Series doors are 1-3/4" (45mm) thick.

### THE USE OF HIGH GLOSS PAINT IS NOT RECOMMENDED.

High gloss paint accentuates the visibility of all welds.

## Installation

1. Installation shall conform to the published Steelcraft installation instructions, ANSI A250.11-2001 (formerly SDI 105) *Recommended Erection Instructions for Steel Frames and HMMA 840*.
2. Fire Rated Assemblies must be in accordance with NFPA Pamphlet 80. The *Authority Having Jurisdiction* is the final authority on issues related to the installation and use of installed Fire Rated Doors.
3. See Sound Openings section on page 243 for optional B-Door construction.

**Note 1:** For optional B-Door construction with STC-Stiffened Core, see SPECIALTY PRODUCTS: SOUND OPENINGS section page 243.

## Features and benefits

Steelcraft's B Series doors offer the following standard unique features, which enhance long term performance and durability:

1. **Steel Stiffened core construction** with welded 20 gauge hat section stiffeners.
2. **Full Height, Epoxy Filled Mechanical Interlock Edges** provide structural support and stability the full height of the door edges. Available edge options:
  - **Visible Edge Seam (standard):** full height, epoxy filled mechanical Interlocked edges
  - **Filled Seam:** optional edge seam epoxy filled and finished smooth. Includes tack welds above and below edge cutouts for hinges, locks, etc
  - **Welded Edge Seam:** optional edge seam welded with 1" (25mm) long weld, 2" (51mm) on center, epoxy filled between welds and finished smooth; available on B18, B16, and B14 doors.
3. **Universal Hinge Preparations** (patented) allow for easy field conversion from standard weight .134" (3.3mm) hinges to heavy weight .180" (4.7mm) hinges.

**14 Gauge [0.067" (1.7mm)] Inverted Top and Bottom Channels** provide stability and protection for the top and bottom edges from abuse.

4. **Beveled Hinge and Lock Edges** allow for tighter installation tolerances, ensure easier operation and eliminate binding and sticking.
5. **Recessed Dezipner™ Glass Trim** provides a clean, neat and flush finish with the door surface.
6. **Factory Applied Baked-On Rust Inhibiting Primer** paint in accordance with ANSI A250.10-1998 (R2004).

## Specification compliance

1. Door construction for Steelcraft B Series full flush doors meets the requirements of ANSI A250.8-2003 (SDI 100).
2. Hardware preparations and reinforcements are in accordance with ANSI A250.6-2003. Locations are in accordance with ANSI/DHI A115 unless otherwise stated.

## Fire ratings

B Series doors meet the broadest fire rating requirements. They are listed for installations requiring compliance to both neutral pressure testing (ASTM E152 and UL-10B) and positive pressure standards (UL-10C).

## Core construction

Steel Stiffeners with Fiberglass Insulation

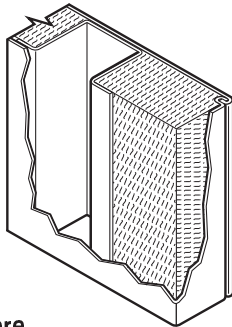

Steel Stiffeners with Fiberglass Insulation

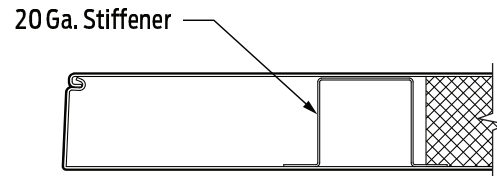

### Standard B Series Core

- 20 gauge stiffeners
- Stiffeners welded to inside of (1) face sheet and bonded to the opposite face
  - Vertical interior webs located 6" (152mm) apart
  - Weld spacing 5" (127mm) on center along the full height of each stiffener
- Stiffener height extends full height of door thickness
- Areas between stiffeners filled with nominal 1 pound (453.6g) per ft<sup>3</sup> density fiberglass batt insulation
- For optional B-Door construction with STC-Stiffened Core, see SPECIALTY PRODUCTS: SOUND OPENINGS on page 245.

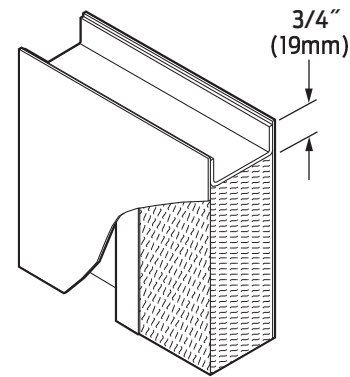
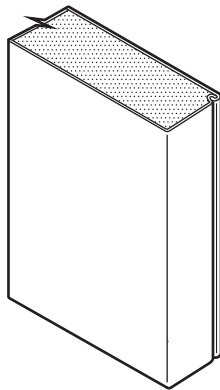

### Standard Premium Edge Construction

- Beveled hinge & lock edges
- Full height mechanical interlock with epoxy adhesive
- Visible edge seam standard
- Seamless edge optional

### Standard Rigid 14 Gauge End Channel Construction

- 14 gauge inverted galvanized top & bottom channels
- Projection welded to both face sheets
- Optional 24 gauge galvanized top caps

## Door application and usage

Series	Steel Thickness	Opening	Usage Frequency	
B18	18 Ga (1.0mm)	Interior: Cold Rolled Steel	Heavy Duty	Heavy Commercial & Institutional applications with high use
B18	18 Ga (1.0mm)	Exterior: Galvanized Steel		
B16	16 Ga (1.3mm)	Interior: Cold Rolled Steel	Extra Heavy Duty	Extra Heavy Commercial applications with potential of very high use
B16	16 Ga (1.3mm)	Exterior: Galvanized Steel		
B14	14 Ga (1.7mm)	Interior: Cold Rolled Steel	Maximum Duty	Extra Heavy Commercial applications with extremely high use
B14	14 Ga (1.7mm)	Exterior: Galvanized Steel		

## Standard hardware preparations

Typical hardware applications shown. Refer to “Hardware” section for more details.

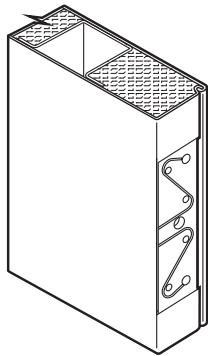

**Universal Mortise Hinge Prep**  
7 Gauge Universal hinge reinforcement

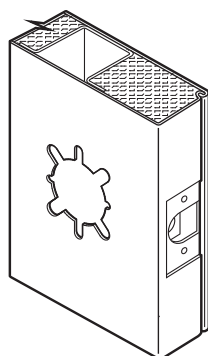

**61L Lock**

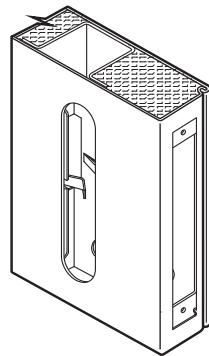

**86 Lock**

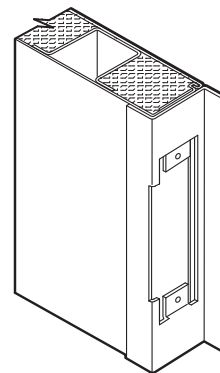

**Inactive Leaf ASA Strike Prep with Astragal attached**

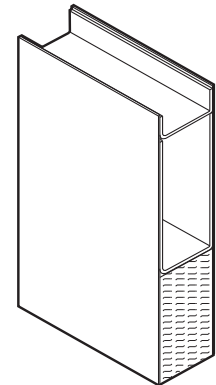

**Optional 14 Gauge Closer Reinforcement**

### Standard: mortised and reinforced for:

- Patented Universal hinge preparations allow for easy field conversion from standard 4-1/2" x .134" standard weight hinges to 4-1/2" x .180" heavy weight hinges. Optional hinge preparation for 5" x .146" standard weight hinges or for 5" (127mm) x .190" (4.8mm) heavy weight hinges is also available.
- The cylindrical 161, 61L and mortise 86 lock preps are the most commonly used active leaf preparations. The 4-7/8" (124mm) strike prep is the most commonly used inactive leaf preparation.
- Optional reinforcements for surface and concealed Closers are available.
- Special hardware applications are available.

### Door Sizes and ANSI A250.8 Conversions

Steelcraft product selection for B Series doors has been matched to ANSI/SDI Level and Model designations.

- In accordance with ANSI A250.8, core material is not specific to the level or model designations. Core material selection is specified based on preference and application.
- Recommended minimum frame gauge also applies to the frequency of operation of the opening.

Series	ANSI A250.8 - SDI 100			Construction Options	Edge Maximum Sizes		Recommended Gauge of Frame
	Level	Model	Description		Single	Pair	
<b>Level 2: Heavy Duty Commercial &amp; Institutional</b>							
B18	2	1	Full Flush	Visible Epoxy Filled	4'0" x 10'0" 1219mm x 3048mm	8'0" x 10'0" 2438mm x 3048mm	16 Gauge [0.053" (1.3mm)]
BF18		2	Seamless				
BW18		2	Seamless	Welded			
<b>Level 3: Extra Heavy Duty Commercial &amp; Institutional</b>							
B16	3	1	Full Flush	Visible Epoxy Filled	4'0" x 10'0" 1219mm x 3048mm	8'0" x 10'0" 2438mm x 3048mm	16 Gauge [0.053" (1.3mm)] 14 Gauge [0.067" (1.7mm)]
BF16		2	Seamless				
BW16		2	Seamless	Welded			
<b>Level 4: Maximum Duty Commercial &amp; Institutional</b>							
B14	4	1	Full Flush	Visible Epoxy Filled	4'0" x 10'0" 1219mm x 3048mm	8'0" x 10'0" 2438mm x 3048mm	14 Gauge [0.067" (1.7mm)]
BF14		2	Seamless				
BW14		2	Seamless	Welded			

## Door edge construction

- Vertical edges (both hinge and lock) are beveled 1/8" (3.2mm) in 2" (51mm) with a visible seam.
- Top and bottom edges are closed with inverted 14 gauge [0.067" (1.7mm)] welded channels. Exterior applications require the addition of top caps to protect against the weather
- Optional Edge Seams available in the B Series doors:
  - BF**: the mechanical edge seam is filled and finished prior to applying the factory primer.
  - BW**: the mechanical edge seam is welded and finished prior to applying the factory primer.

### Full flush

#### B Series Visible Seam Features

- Full height mechanical interlock
- Interlock filled with epoxy adhesive
- Visible edge seam

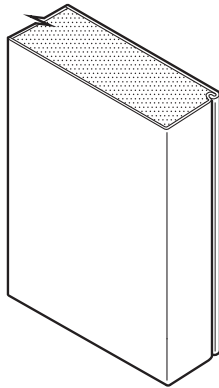

### Seamless

#### BF Series Seam Filled Features

- Full height mechanical interlock
- Interlock is tack welded and filled with epoxy adhesive
- Edge seam is epoxy filled and finished
- No visible edge seam

#### BW Series Seam Welded Features

- Full height mechanical interlock
- Edge is seam welded 1" (25mm) long, 2-2.5" (51-64mm) O.C.
- No visible edge seam

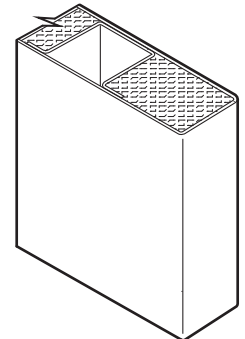

## Glass light options (Refer to the Lights and Louvers section for further details)

#### Designer® Trim

- Standard for 1/4" Thick Glass
- Optional for 1/2" Thick Glass

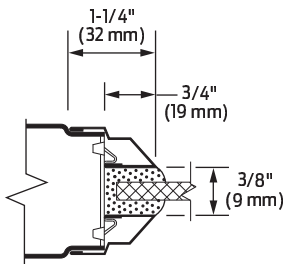

#### Flush Mounted Steel Trim

- For 1" Thick Glass

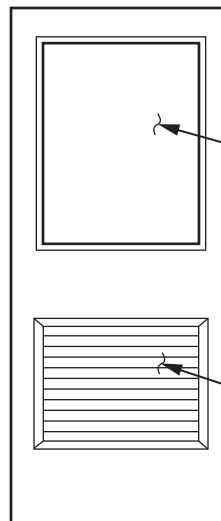
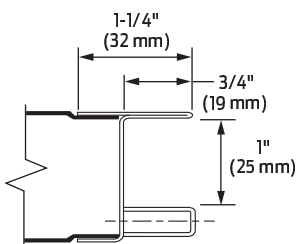

**Note:** Glazing type and thickness vary per job requirements.

**Note:** Louver size and type vary per requirements.

Divider Muntins Are Not Available